

How to take a Student Survey

HOPE
Academy
OF WEST MICHIGAN



**LIGHTHOUSE
ACADEMY**

Today's Survey Part 1

- **To better support you, your school and teachers would like to ask you some questions about your experiences in school.**
- **We would like to learn more about you! This survey will help your teachers and schools provide you with the best education possible.**

Today's Survey Part 2

- Only your teachers and school leaders will be able to see your responses, and these responses **will not be used as class grades.**
- We want you to **respond honestly**—there are no right or wrong answers!
- **Your voice is important, so thank you** for sharing about your thoughts and experiences.

Making Selections

- Under each question, you will see answer choices.
- Choose the best answer choice for you.

Rigorous Expectations & Safety

For the following questions, we are interested in learning more about how you think about your school. Please give us your honest opinions so that we can better understand your experience and work to make the school a better place.

How well do students follow the rules of your school? *

Choose

Not well at all

A little well

Somewhat well

Very well

Extremely well

where you go to school? *

this school? *

Translation

If you need to translate the survey, click the drop-down menu in the top right corner.

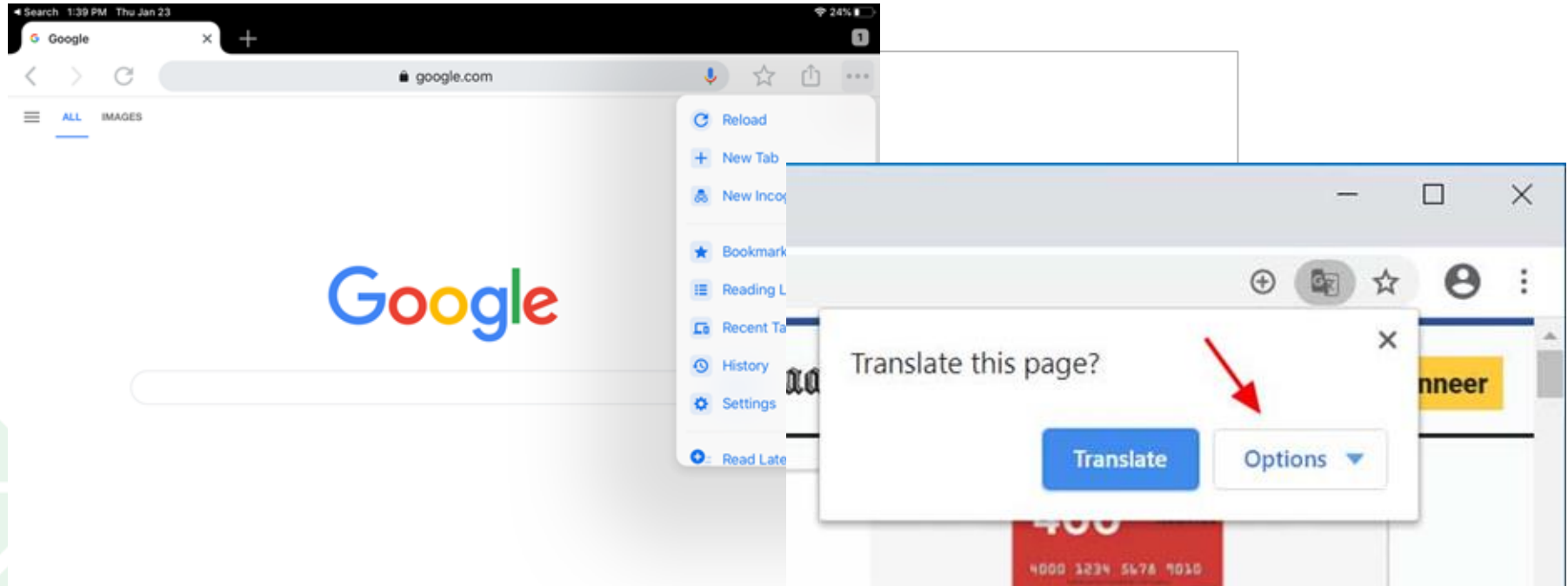

Read Aloud

Text to Speech

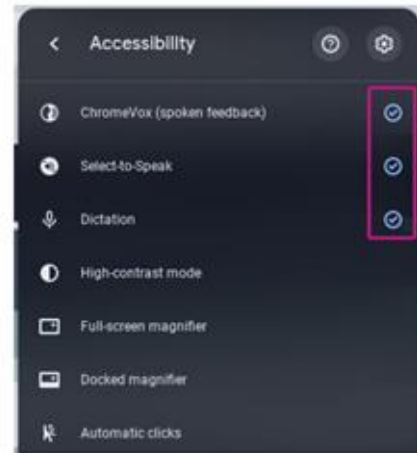
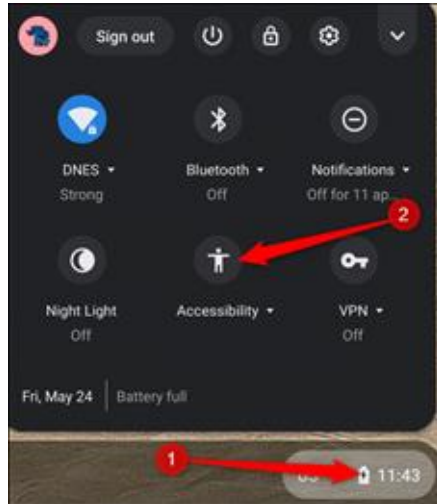

- Press and hold the Search key + select a line of text.
- Press and hold the Search key + drag the pointer over an area of the screen.
- Highlight the text and press Search+S.

How to Access Surveys

To access your survey(s), you will need an electronic device with internet access (laptop, computer, **tablet**, or smartphone, etc.).



Student Survey Grades 4-12

For the following questions, we are interested in learning more about how you think about your school.
Please give us your honest opinions so that we can better understand your experience and work to make the school a better place.

[Next](#) [Clear form](#)

Step 1

Go to the following website (type it exactly as it appears):

<https://forms.gle/ALyiQSKhZ4BY7r1K9>



Make sure to check-in with
your teacher for the correct
link.

Step 2

Make sure the
information is
correct.



Student Survey Grades 4-12

For the following questions, we are interested in learning more about how you think about your school.

Please give us your honest opinions so that we can better understand your experience and work to make the school a better place.

Next

Clear form

Step 3

- You will start with the questions.
- Read the first question.



Student Survey Grades 4-12

For the following questions, we are interested in learning more about how you think about your school.

Please give us your honest opinions so that we can better understand your experience and work to make the school a better place.

Next

Clear form

Questions 1 & 2

What is your current grade level *

Choose ▼



What is your race? (mark all that apply) *

- ☐ American Indian or Alaskan Native
- ☐ Asian
- ☐ Black or African American
- ☐ Native Hawaiian or Pacific Islander
- ☐ White
- ☐ I prefer not to answer

Next

Clear form

Step 4

- Choose an answer for each question. **Please do your best.**
- Click the  button at the bottom of the page once you are done.
- Please make sure you are completely finished before  submit.
- You will not be able to change your selections once you have submitted your answers.

Step 5

When you have finished taking your survey, you will see this screen indicating you are all done!

